

---

# **Bolens<sup>®</sup>**

**Mower Attachment  
48 Inch**

**Model 18336**

Serial Numbers 0100101  
thru 0199999

**Parts List**

# BOLENS 48 INCH MOWER ATTACHMENT

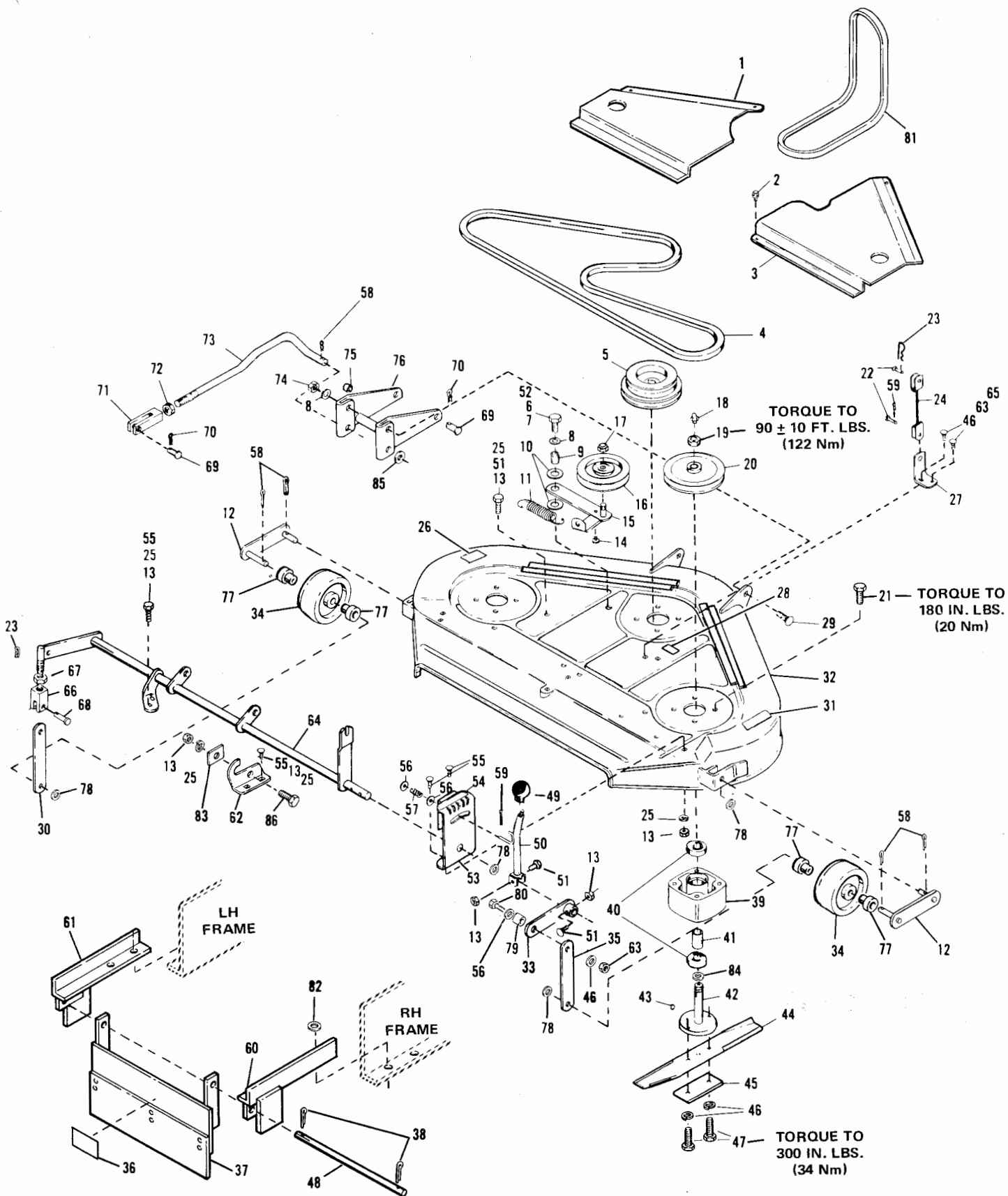

REF. NO.	PART NO.	DESCRIPTION	NO. REQ'D.	REF. NO.	PART NO.	DESCRIPTION	NO. REQ'D.
1	1738012	Belt Cover, L.H. . . . .	1	44	1726138	Cutter Blade . . . . .	3
2	1185750	Flange Lock Screw, Self Drilling Screw, No. 10-24 x 5/8. . . . .	4	45	1724051	Plate . . . . .	3
3	1738011	Belt Cover, R.H. . . . .	1	46 ●	1100243	Washer, Lock 3/8 . . . . .	9
4	1736903	V-Belt . . . . .	1	47 ●	1100009	Cap Screw, 3/8-24 x 1 . . . . .	6
5	1728108	Drive Sheave . . . . .	1	48	1735872	Rod . . . . .	1
6	1734514	Lock Nut, 1/2-13 . . . . .	1	49	1724231	Knob . . . . .	1
7 ●	1100064	Cap Screw, 1/2-13 x 1-1/2. . . . .	1	50	1731777	Adjustment Rod Assy. . . . .	1
8 ●	1107385	Flat Washer, 1/2 . . . . .	3	51 ●	1100779	Screw, Hex Hd, 5/16-18 x 1-3/4. . . . .	3
9	1728030	Sleeve Bearing . . . . .	1	52 ●	1100245	Lock Washer, 1/2 . . . . .	1
10	1724929	Thrust Washer . . . . .	2	53	1734551	Lift Quadrant . . . . .	1
11	1724822	Extension Spring . . . . .	1	54	1731800	Decal (Cutting Ht. Adj.) . . . . .	1
12	1738476	Gage Wheel Support Assy. . . . .	2	55 ●	1186099	Carriage Bolt, 5/16-18 x 7/8 . . . . .	6
13 ●	1732499	Flange Nut, 5/16-18. . . . .	11	56 ●	1100255	Flat Washer, 3/8 . . . . .	3
14	1724924	Wear Button . . . . .	1	57	1728075	Compression Spring . . . . .	1
15	1728020	Idler Arm Assembly . . . . .	1	58 ●	1100351	Cotter Pin, 1/8 x 1 Lg. . . . .	6
16	1724925	Idler Pulley . . . . .	1	59 ●	1100346	Cotter Pin, 3/32 x 3/4 . . . . .	2
17 ●	1186247	Hex Nut Jam, 1/2-20 . . . . .	1	60	1738074	R.H. Stop Assy. . . . .	1
18	1185976	Grease Fitting . . . . .	3	61	1738073	L.H. Stop Assy. . . . .	1
19 ●	1185093	Hex Nut, 3/4-16 . . . . .	3	62	1728646	Rod Support . . . . .	1
20	1727555	Blade Sheave . . . . .	2	63	1733398	Lock Nut, 3/8 x 16 . . . . .	3
21	1724491	Screw, Flange Lock, 5/16 x 18 x 3/4. . . . .	12	64	1738481	Shaft Assembly . . . . .	1
22	1112587	Clevis Pin, 3/8. . . . .	2	65 ●	1186128	Carriage Bolt, 3/8-16 x 1. . . . .	2
23	1703011	Spring Cotter . . . . .	2	66	1731772	Rod End . . . . .	1
24	1728672	Lift Cable . . . . .	1	67 ●	1186249	Jam Nut, 5/8-18 . . . . .	1
25 ●	1100242	Lock Washer, 5/16. . . . .	9	68	1890227	Clevis Pin . . . . .	1
26	1736573	Decal . . . . .	1	69	1719324	Clevis Pin . . . . .	4
27	1728007	Lift Bracket . . . . .	1	70	1723478	Hitch Pin . . . . .	4
28	1728982	Decal (Belt Drive) . . . . .	1	71	1714573	Rod End . . . . .	2
29 ●	1186184	Carriage Bolt, 1/2-13 x 1-3/4. . . . .	2	72	1186235	Hex Nut, 5/8-11 . . . . .	2
30	1738653	Connecting Link . . . . .	1	73	1739392	Tie Rod, L.H. . . . .	1
31	1737066	Decal (Cut Line) . . . . .	1		1738102	Tie Rod, R.H. . . . .	1
32	1738499	Base Assembly . . . . .	1	74	1185496	Self Lock Jam Nut, 1/2-13 . . . . .	2
33	1738486	Lift Link Assy. . . . .	1	75	1728121	Sleeve Bearing . . . . .	2
34	1717649	Gage Wheel . . . . .	2	76	1737160	Drag Link Assy. . . . .	1
35	1738473	Bar . . . . .	1	77	1729299	Flange Bearing . . . . .	4
36	1737067	Caution Decal . . . . .	1	78	1185830	Washer . . . . .	5
37	1736945	Guard Assy. . . . .	1	79	1738160	Spacer . . . . .	1
38 ●	1100362	Cotter Pin 3/32 x 1/2. . . . .	2	80 ●	1100043	Hex Screw 3/8-16 x 1-1/4. . . . .	1
39	1724029	Spindle Housing . . . . .	3	81	1739080	V-Belt . . . . .	1
40	1185828	Ball Bearing . . . . .	6	82 ●	1107383	Flat Washer, 3/8 . . . . .	4
41	1724033	Spacer . . . . .	3	83	1741586	Rod Retainer . . . . .	1
42	1739890	Shaft Assembly . . . . .	3	84	1740627	Special Washer . . . . .	3
43	1104436	Woodruff Key, 3/16 x 3/4. . . . .	3	85 ●	1107387	Flat Washer 3/4. . . . .	2
				86 ●	1100078	Hex Screw 5/16-18 x 7/8 . . . . .	1
				NI	1736796	Spray Paint, Dark Green	

● Common hardware purchase locally (Grade 5 where applicable).